

KIT International Community House



The three-story KIT International Community House opened its door to the international students in 2018. It locates within 5-minuets walking distance from KIT Ohgigaoka campus.

【1st Floor】

1st Floor



A. This is a **Learning Space** which is customizable according to purposes. It can become a presentation space, or be used for group learning or seminars.



B. **Communication Circles** provide a variety of communication spaces to relax in your own style.



C. Common kitchen equipped with IH cooking heaters, microwaves, rice cookers, refrigerators, coffee brewers, various kinds of cookware, and dishes. This is used for special occasions only and the residents are encouraged to use a kitchen in each unit for daily meals.

<2nd and 3rd Floors>

The 2nd and 3rd floors are living spaces for the KIT JLP participants. There are 5 housing units on each floor. Five people stay in one unit sharing 2 shower rooms, toilets, laundry machine, and a kitchen.

Each Unit Layout

2nd & 3rd Floor (5 Units each floor)

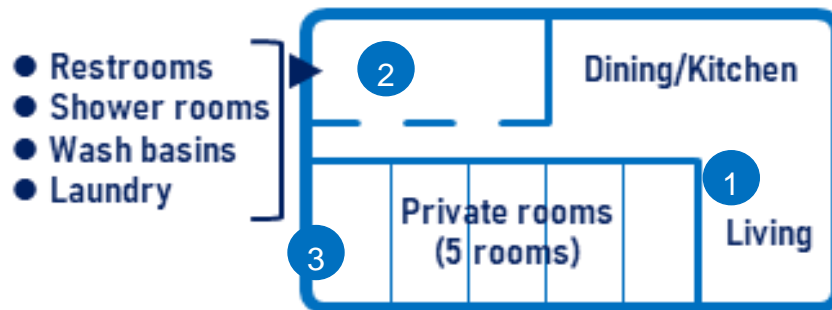

TV space, dining place, and a kitchen inside the Unit. The kitchen is equipped with IH cooking heater, toaster, rice cooker, microwave, refrigerator, cookware, and dishes and kitchen utensils.



Shower rooms, washing machine (without dryer), and toilets. You need to prepare your shampoo, rinse, and laundry detergent by yourselves.



A single room furnished with an air conditioner, bed, study desk, and a closet. A bedding set (bed pad, blanket, pillow and sheets) are provided to each participant.